

PROFIL

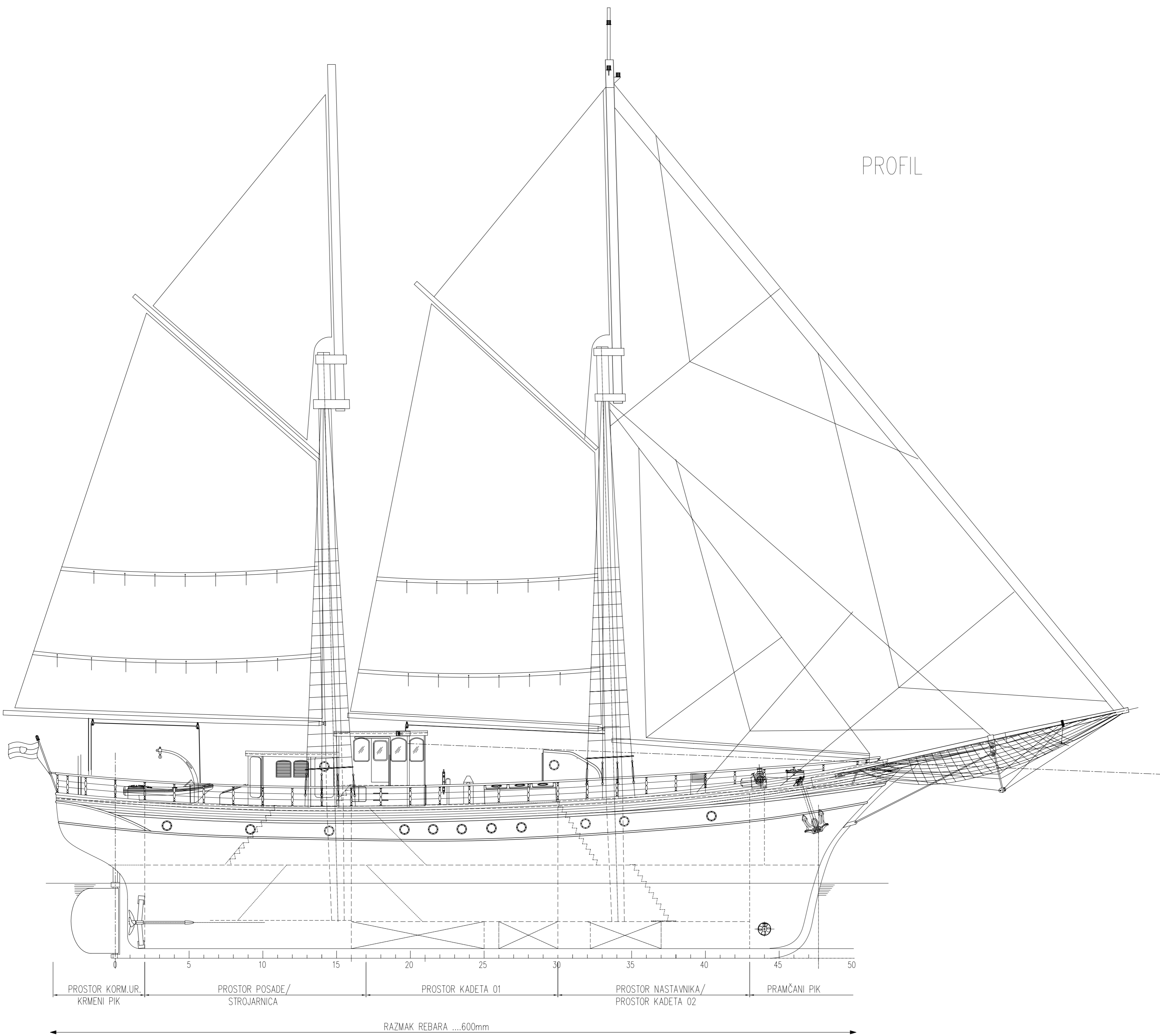

GLAVNA PALUBA

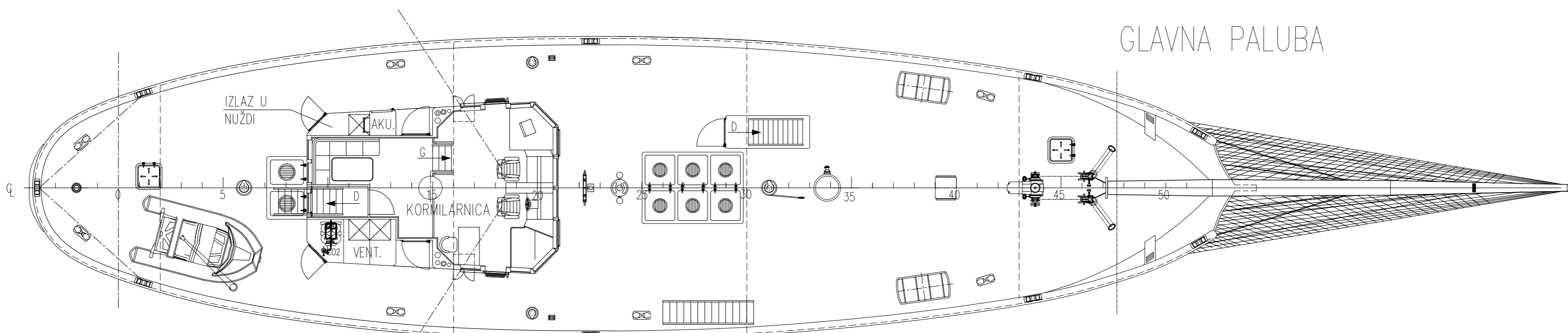

MEDUPALUBA

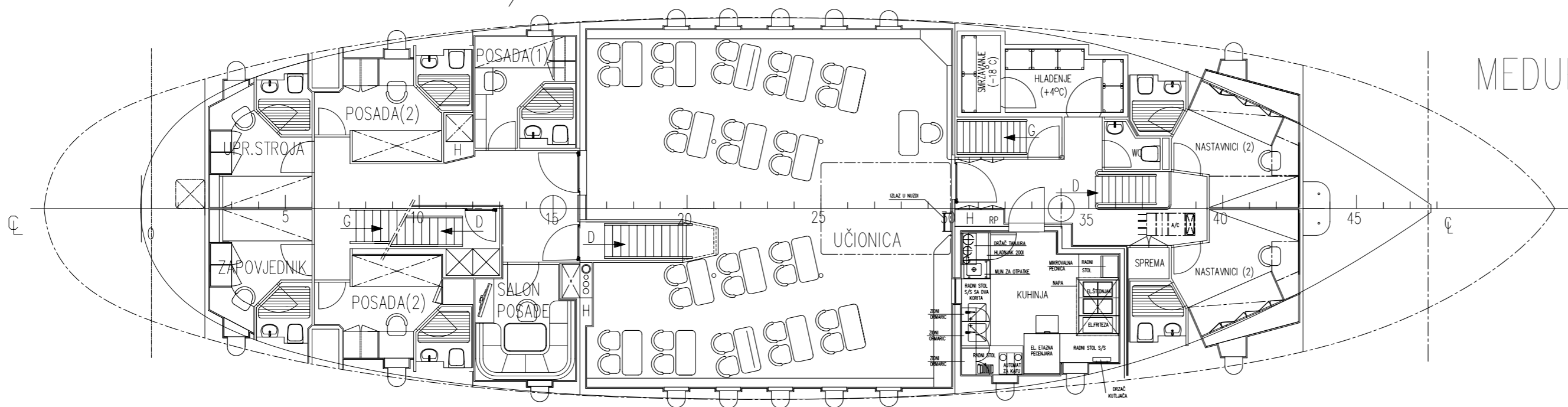

DONJA PALUBA

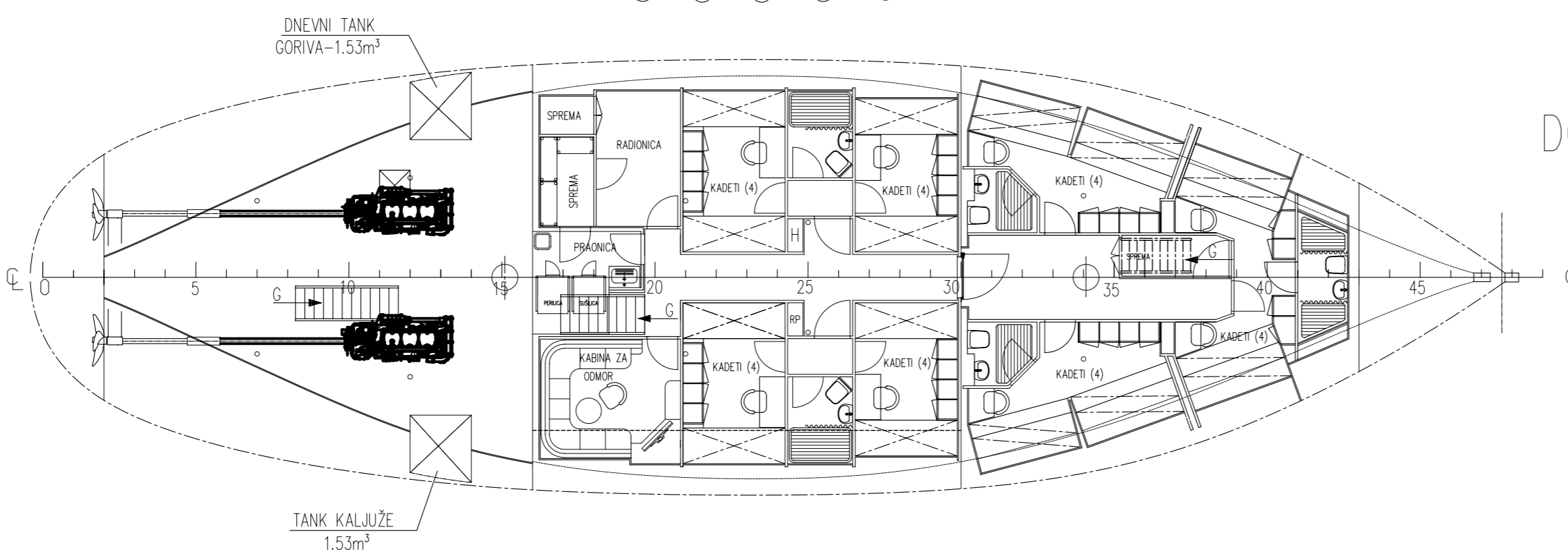

GLAVNE ZNAČAJKE:

Duljina trupa preko svega oko	35.00m
Duljina između okomica	28.60m
Širina na rebrima	8.55m
Visina (najmanja)	5.60m
Visina preko jarbola	36.55m
Gaz(od dna kobilice)	3.05m
Istisnina pri gasu	3.05
376 t	
Broj članova posade	7
Broj učenika i nastavnika	28+4
Brzina na jedra	cca. 6 čv.
Brzina s motorima	cca. 11čv.

TANKOVI

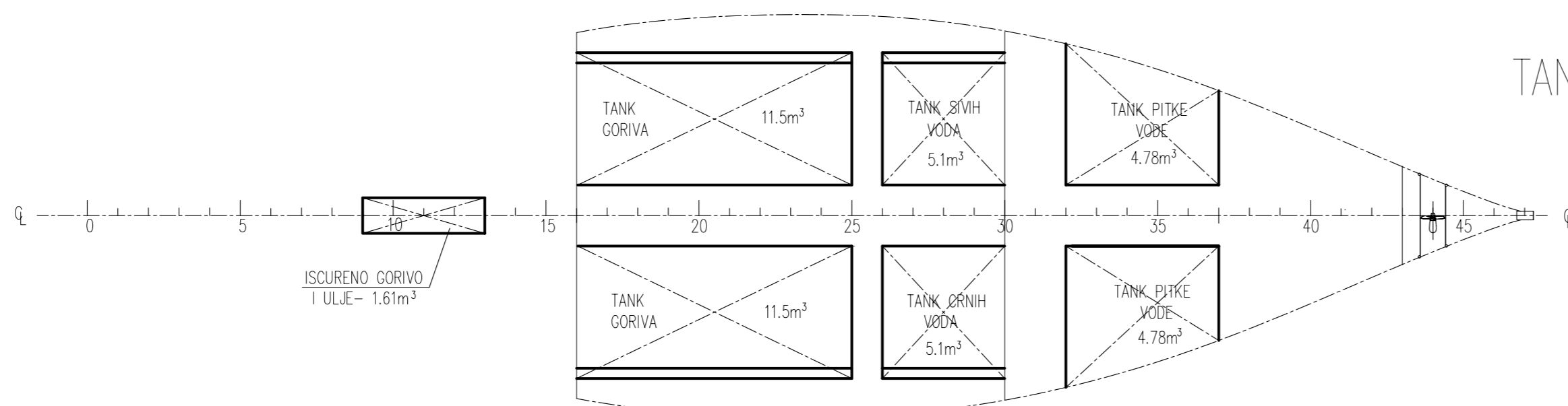

DORADENO 25.05.2008 - YACHT DESIGN d.o.o. - N.Flesch
 DORADENO 22.05.2008 - YACHT DESIGN d.o.o. - N.Flesch
 DORADENO 12.05.2008 - YACHT DESIGN d.o.o. - N.Flesch
 DORADENO 27.04.2008 - YACHT DESIGN d.o.o. - N.Flesch
 DORADENO 30.03.2008 - YACHT DESIGN d.o.o. - N.Flesch

Naručilac: MINISTARSTVO MORA, TURIZMA, PROMETA I RAZVITKA		Objekt: LOGER34 - ŠKOLSKI BROD	
Mjerilo: 1:100	Mesa: _____	Zamjena sa: _____	Veza sa: _____
Datum: 10-2006	Naziv: _____	IDEJNI PROJEKT	
Obrađio: mr.sc./P.H.M. d.đ.	OPĆI PLAN		
Projektor: M.Fabjan, dipl.ing.			
Pregledao: M.Bilić, dipl.ing.			
Suglasom: A. Babić, inž.			
Odobrio: M.Bilić, dipl.ing.			
c Tankovi 11-2007	Kopija: _____	Oznaka: _____	List: 1
b Nadgradje 03-2007	_____	Reg. br. 9-3-450	Int.oznaka: BC-J09-CAM00-000
a Snas 12-2006	_____	_____	_____
St. i. Izmjena Datum Ime	_____	_____	_____